

BB-8 Head- Princess Leia



Final

BB-8 Head- Princess Leia



Step 1:

Tape half of a golf ball with masking tape.



Step 2:

Use Café au Lait to start Doodling the head.



Step 3:

Carefully take off the Doodled head off the golf ball.
(It will be easier to take it off after adding the details)



Step 4:

Next, the hair. Doodle two half semicircles using Brownie Brown for the back of the hair.

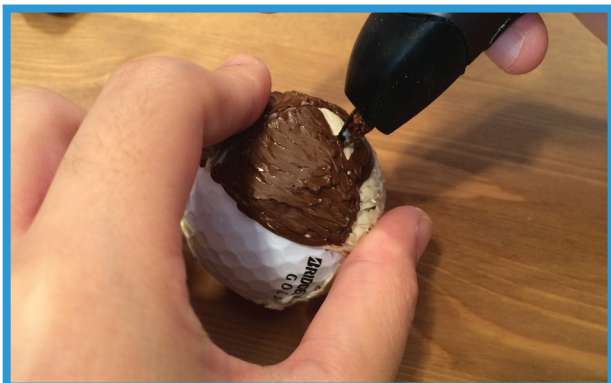

Step 5:

Then add on some curves for Princess Leia's bangs



Step 6:

After that, add her side buns by constantly Doodling circles

BB-8 Head- Princess Leia



Step 7:

You Doodle over the circles for more hair details.



Step 8:

Next, Doodle her other bun on the other side.



Step 9:

After that, add her facial details. Doodle a nose.



Step 10:

And her eyes.

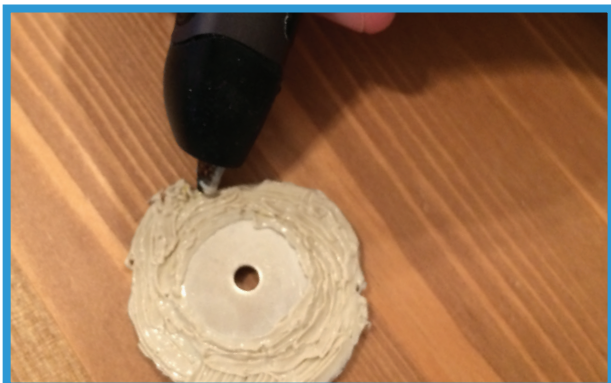

Step 11:

Last but not least, create a base for the head to stand on the BB-8. Doodle around the magnet.



Step 12:

Make sure it fits the bottom of the head, then stick them together.